



Designa CONNECT LANE 600 FULL OUT

The new DESIGNA generation of exit control terminals stands out due to its clever and modular design and its modern, cutting-edge technology.

The positioning of the operating elements and a user-friendly touch display guarantee simple operation and therefore a smooth parking process. An additional display is available for displaying individual digital content.

FEATURES

- TFT-touch display (10.1") with integrated functions and graphical user instructions.
- TFT color display (24") for displaying digital content, e.g. dynamic pricing developments, occupancy data, routing directions or advertising (optional).
- High-quality, gloss-finish front control panel with integrated illuminated ring.
- Automatic stand-by mode reducing power consumption to 35 W.
- Processing tickets and cards with mag-stripe or barcode.
- Acceptance of transient tickets, monthly cards, value cards, credit cards, debit cards and special tickets.
- Processing speed less than 0.7 seconds.
- Vehicle counting according to the type of ticket.
- Active fraud protection: If a black listed ticket is used at the exit, the operating system will automatically withdraw it and send a warning message.
- I/O sequence check.
- Rate calculation including discount processing.
- Ticket bag for withdrawn tickets.
- Integral intercom device.
- Ethernet connection

SELECTABLE TECHNOLOGIES

Barcode

Barcode reader for processing barcode tickets.

Mag-stripe

Mag-card reader for processing side and/or central stripe tickets.

BASIC EQUIPMENT

- TFT-touch display (10.1") for operation and display of graphical user instructions.
- High-quality, gloss-finish front control panel with integrated, illuminated ring.
- Ticket bag for withdrawn tickets.
- Ethernet connection.
- Fan.

OPTIONS

- TFT color display (24") for displaying digital content, e.g. rates, routing directions, occupancy data or advertising.¹
- Mag-card reader for processing central stripe tickets with 4-way insertion to minimize operating errors.²
- Secure card reader for the use of credit cards and debit cards as transient parker tickets. Receipt printout after payment.³
- Contactless prox cards, ISO 15693, as well as other short and medium range RFID systems for the identification of contactless monthly/contract parker cards.
- Camera for network-based video surveillance.

¹ optional equipment not available in all countries

² with magnetic stripe technology

³ country-specific

FURTHER OPTIONS

- 2D Barcode scanner.
- DESIGNA VoIP: SIP-compatible intercom unit.
- Installation of customized intercom devices.
- Software regulated heater.
- Humidity sensor.
- Key switch.
- Mechanical button intercom
- Voice output for user guidance
- I/O board functionality.
- Socket with residual current circuit breaker.
- Custom colors available.
- Ram protection posts.
- Foundation frame/mounting kit.

DESIGN

- Housing body and base door made of stainless steel 1.4301 (V2A), outer and inner surface with durable, weather-resistant powder coating, fine structure deep matt color.
- Housing door is made of plastic (ASA), wet painted.
- Front panel is made of PLEXIGLAS®.
- Housing door and base door secured with lock.
- Housing body and base door: RAL 7012 (basalt gray), RAL 9016 (traffic white).
- Housing door and modular front panel: RAL 9017 (traffic black).

TECHNICAL DATA

- Type: OUT_01
- Power supply: 120 V AC, 60 Hz
- Current consumption:
 - device: operation 0.4 A, max. 0.83 A
 - standby mode: 0.29 A
 - heater: 1.5 A (with heater 180 W), 3.33 A (with heater 400 W)
- Power consumption:
 - device: operation 48 W, max. 100 W
 - standby mode: 35 W
 - TFT display 24": 75 W
 - heater (optional): 180 W, 400 W
- Network system: TN-S System
- Pre-fuse: max. 13 A
- Max. wire size: AWG 14
- Connection type: tension spring
- Protection class: I
- Control voltage: 24 V DC
- Rating: IP 54
- Laser class barcode scanner: Class 2
- Temperature:
 - Operation: +50°F to +122°F (+10 to +50°C)
 - with heater: -4°F to +122°F (-20 to +50°C)
 - storage: -13°F to +122°F (-25 to +70°C)
- Weight: approx. 110 lbs (50 kg)
- Dimensions: see figure.

CERTIFICATION

- UL File Number: E219269

DRAWING, DIMENSIONS IN INCH (MM)

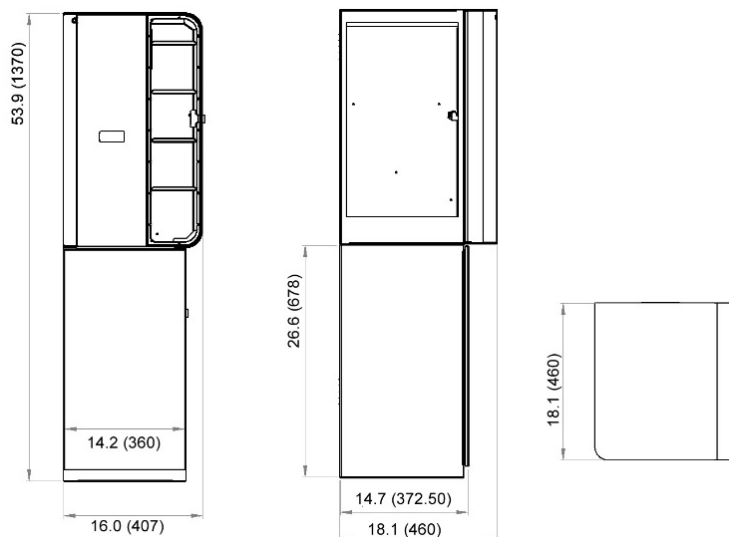

CONTACT

DESIGNA US Headquarters
 DESIGNA-NextGen
 4401 S. Pinemont Dr, Suite 200
 Houston, Texas 77041
 Phone (713) 776-8324
sales.usa@designa.com
us.designa.com