



# Designa CONNECT LANE 600 FULL IN

The new DESIGNA generation of entrance control terminals stands out due to its clever and modular design and its modern, cutting-edge technology. The positioning of the operating elements and a user-friendly touch display guarantee simple operation and therefore a smooth parking process. An additional display is available for displaying individual digital content.

## FEATURES

- TFT-touch display (10.1") with integrated functions and graphical user instructions
- TFT colour display (24") for displaying digital content, e.g. dynamic pricing developments, occupancy data, routing directions or advertising (optional)
- High-quality gloss finish of the front control panel with integrated illuminated ring
- Automatically switches to standby mode reducing power consumption to 35 W
- Processing tickets and cards with magnetic strip or barcode technology
- Issue of short-term parking tickets and acceptance of season parker cards, value cards, credit cards, debit cards and special tickets
- High issuing speed for short term parker tickets with imprint Vehicle counting according to the type of ticket
- Ticket magazine for up to 10,000 tickets
- Ticket issuing after using the touch button for ticket request or automatically after occupying the induction loop (express entrance)
- Multiple swindling protection: Ticket issuing only after the induction loop has been occupied, message if passage does not occur
- Inside/outside check
- Ticket issuing automatically blocked if the car park is occupied
- Automatic switching for the display free/occupied
- Intercom device
- Ethernet connection

## SELECTABLE VERSIONS

### Barcode

- Barcode card reader for processing barcode tickets, with printer for printing barcodes and car park data, entrance time and ticket number onto coated paper tickets

### Magnetic strip

- Magnetic card reader for processing side and/or central strip tickets, with printer for printing car park data, entrance time and ticket number on uncoated or coated paper tickets

## BASIC EQUIPMENT

- TFT-touch display (10.1") for operation and display of graphical user instructions (country-specific)
- High-quality gloss finish of the front control panel with integrated illuminated ring
- Ticket magazine with up to 5,000 paper tickets
- Adjustable ticket shortage message

- Ethernet connection
- Fan

## OPTIONS

- TFT colour display (24") for displaying digital content, e.g. tariffs, routing directions, occupancy data or advertising<sup>1</sup>
- Additional ticket magazine for a total of up to 10,000 paper tickets, with automatic switching between magazines
- Magnetic card reader for processing central strip tickets in all 4 insertion directions in order to minimise operating errors and optimise throughput<sup>2</sup>
- Credit cards and debit cards can be used as short term parker tickets

<sup>1</sup> optional equipment not available in all countries

<sup>2</sup> with magnetic strip technology

## FURTHER OPTIONS

- Hands-free entrance control with smart card system (RFID), such as Mifare, Legic, ISO 15693, as well as other short, medium and long range RFID systems
- Installation of customised readers
- Automatic ticket retraction of short term parker tickets which have not been removed
- Driver camera
- 2D Barcode-Scanner
- DESIGNA VoIP: SIP-compatible intercom unit
- Installation of customised intercom devices
- Software regulated heater
- Humidity sensor
- Inductive hearing loop
- Key switch
- Sensor surface ticket request
- Mechanical button intercom
- Voice output for user guidance
- I/O board functionality
- Socket with residual current circuit breaker
- Surge arrester
- Special customised colour
- Ram protection posts
- Foundation frame/mounting kit

## DESIGN

- Casing body and socket door made of stainless steel 1.4301 (V2A), outer and inner surface with durable, weather-resistant powder coating, fine structure deep matt colour
- Casing door is made of plastic (ASA), wet painted
- Front panel is made of Plexiglas XT
- casing door and socket door secured with lock
- Casing: RAL 7012 (basalt grey), RAL 9016 (traffic white)
- Casing door and front panel: RAL 9017 (traffic black)

## TECHNICAL DATA

- Type: IN\_01
- Voltage supply: 230 V AC, 50 Hz
- Current consumption:
  - device: operation 0.21 A, max. 0.45 A
  - standby mode: 0.15 A
  - heater: 1.8 A
- Power consumption:
  - device: operation 48 W, max. 100 W
  - standby mode: 35 W
  - TFT display 24": 75 W
  - heater: 400 W
- Network system: TN-S System
- Pre-fuse: max. 16 A
- Terminal cross-section: max. 2,5 mm<sup>2</sup>
- Connection type: tension spring connection
- Protection class: I
- Control voltage: 24 V DC
- Rating: IP 54
- Laser class barcode-scanner: Class 2
- Temperature:
  - Operation: +10 bis +50°C
  - with heater: -20 bis +50°C
  - storage: -25 bis +70°C
- Weight: ca. 50 kg
- Dimensions: see figure.

## SYSTEM REQUIREMENTS

- Version X20 and newer

## SAFETY/ REGULATIONS

- EU Declaration of Conformity in accordance with Machinery Directive 2006/42/EC, EMC 2014/30/EU

## FIGURE, DIMENSIONS IN MM

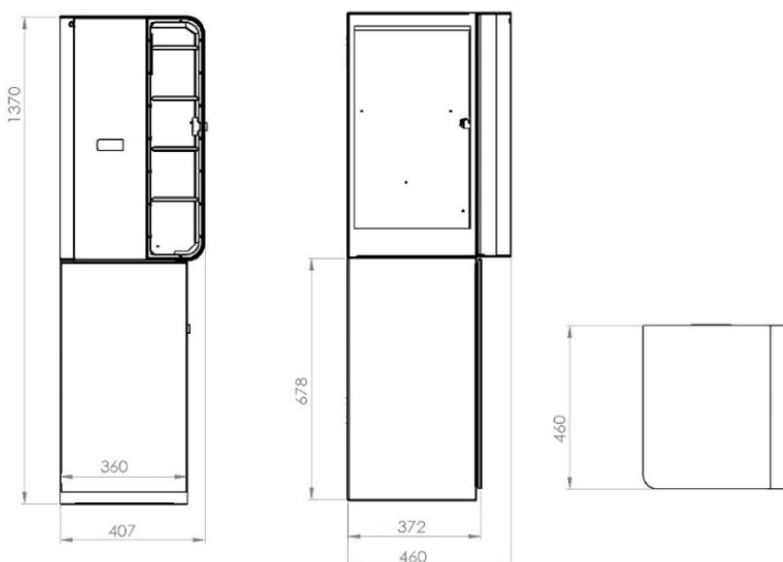

## CONTACT

DESIGNA Verkehrsleittechnik GmbH  
 Faluner Weg 3  
 24109 Kiel, Germany  
 info@designa.com  
 T: +49 (0) 431 5336-0  
 F: +49 (0) 431 5336-260